

API No. <u>42-461-39326</u> Drilling Permit # <u>780304</u> SWR Exception Case/Docket No. <u>7C-0287943</u> (R38)		RAILROAD COMMISSION OF TEXAS OIL & GAS DIVISION APPLICATION FOR PERMIT TO DRILL, RECOMPLETE, OR RE-ENTER <i>This facsimile W-1 was generated electronically from data submitted to the RRC.</i> <i>A certification of the automated data is available in the RRC's Austin office.</i>				FORM W-1 07/2004 Permit Status: Approved	
1. RRC Operator No. 166150		2. Operator's Name (as shown on form P-5, Organization Report) COG OPERATING LLC		3. Operator Address (include street, city, state, zip):			
4. Lease Name JUNE		5. Well No. 8					
GENERAL INFORMATION							
6. Purpose of filing (mark ALL appropriate boxes): <input checked="" type="checkbox"/> New Drill <input type="checkbox"/> Recompletion <input type="checkbox"/> Reclass <input type="checkbox"/> Field Transfer <input type="checkbox"/> Re-Enter <input type="checkbox"/> Amended <input type="checkbox"/> Amended as Drilled (BHL) (Also File Form W-1D)							
7. Wellbore Profile (mark ALL appropriate boxes): <input checked="" type="checkbox"/> Vertical <input type="checkbox"/> Horizontal (Also File Form W-1H) <input type="checkbox"/> Directional (Also File Form W-1D) <input type="checkbox"/> Sidetrack							
8. Total Depth 12000		9. Do you have the right to develop the minerals under any right-of-way ? <input checked="" type="checkbox"/> Yes <input type="checkbox"/> No		10. Is this well subject to Statewide Rule 36 (hydrogen sulfide area)? <input type="checkbox"/> Yes <input checked="" type="checkbox"/> No			
SURFACE LOCATION AND ACREAGE INFORMATION							
11. RRC District No. 7C		12. County UPTON		13. Surface Location <input checked="" type="checkbox"/> Land <input type="checkbox"/> Bay/Estuary <input type="checkbox"/> Inland Waterway <input type="checkbox"/> Offshore			
14. This well is to be located <u>16.6</u> miles in a <u>NW</u> direction from <u>RANKIN</u> which is the nearest town in the county of the well site.							
15. Section 72	16. Block C	17. Survey CCSD&RGNG RR CO/BARBER, P P		18. Abstract No. A-898	19. Distance to nearest lease line: 660 ft.	20. Number of contiguous acres in lease, pooled unit, or unitized tract: 322.85	
21. Lease Perpendiculars: <u>660</u> ft from the <u>SOUTH</u> line and <u>680</u> ft from the <u>EAST</u> line. 22. Survey Perpendiculars: <u>660</u> ft from the <u>SOUTH</u> line and <u>1980</u> ft from the <u>WEST</u> line.							
23. Is this a pooled unit? <input type="checkbox"/> Yes <input checked="" type="checkbox"/> No		24. Unitization Docket No:		25. Are you applying for Substandard Acreage Field? <input type="checkbox"/> Yes (attach Form W-1A) <input checked="" type="checkbox"/> No			
FIELD INFORMATION List all fields of anticipated completion including Wildcat. List one zone per line.							
26. RRC District No.	27. Field No.	28. Field Name (exactly as shown in RRC records)		29. Well Type	30. Completion Depth	31. Distance to Nearest Well in this Reservoir	
7C	85279200	SPRABERRY (TREND AREA)		Oil Well	10000	1320.00	
BOTTOMHOLE LOCATION INFORMATION is required for DIRECTIONAL, HORIZONTAL, AND AMENDED AS DRILLED PERMIT APPLICATIONS							
Remarks 				Certificate: I certify that information stated in this application is true and complete, to the best of my knowledge. <div style="display: flex; justify-content: space-between;"> <div> <u>Roy Johnson, Regulatory Analyst</u> Name of filer </div> <div> <u>Feb 20, 2014</u> Date submitted </div> </div> <div style="display: flex; justify-content: space-between; margin-top: 10px;"> <div> <u>(432)8182218</u> Phone </div> <div> <u>rjohnson@concho.com</u> E-mail Address (OPTIONAL) </div> </div>			
				RRC Use Only Data Validation Time Stamp: Mar 21, 2014 4:45 PM('As Approved' Version)			

Block C,
C.C.S.D. & R.G.N.G. RR. Co.

P.Hamilton
80

73

P.R.Barber
J.L.Barber
60

81

72
P.P.Barber

COG OPERATING LLC

61

C.C.S.D. & R.G.N.G. RR. Co.
Block D,
COG

COG
COG OPERATING LLC

COG

June 322.85 ac

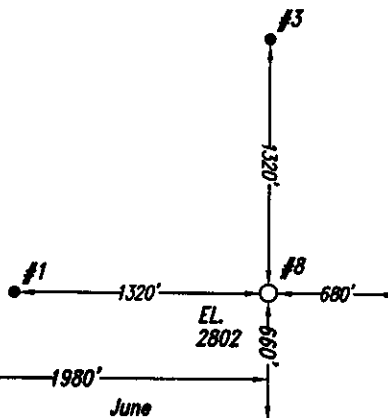

COG 82
P.P.Barber

71

COG

62
T.B.Griffin
P.P.Barber

Note: Survey Reconstruction filed in the Office of Luchini and Mertz Land Surveying Company.

Note: All bearings and coordinates shown are based on the Texas Coordinate System of 1927, Central Zone.

A combined grid factor of 0.999777598 must be divided into distances to obtain a true horizontal distance.

Note: The above sketch represents the location as staked on the ground and is for permit purposes only.

Note: NAD '27 Coordinates & Latitude/Longitude on well location in Section 72.

Note: Well location is approximately 16.6 miles northwest of Rankin.

Note: This does not constitute a boundary survey.

Note: Lease description provided by Client.

X: 1458520.38

Y: 645189.57

Latitude: 31°25'44.63"N Longitude: 102°04'10.09"W

1980' FWL & 660' FSL Section 72

Railroad Commission Drawing

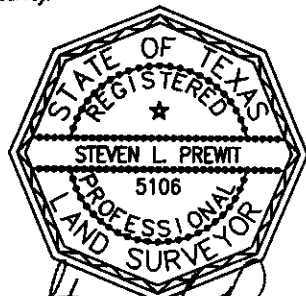

January 15, 2014

140115W4

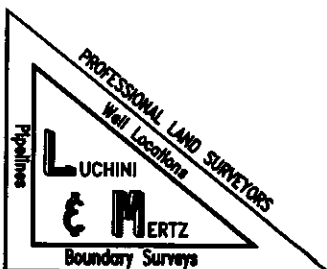

COG OPERATING LLC
"June" Lease #8
NE/4 & SW/4 of
Section 72, Block C,
C.C.S.D. & R.G.N.G. RR. Co.,
Upton County, Texas

Scale: 1" = 1000'